

FOR YOUR CONVENIENCE



Leisure Time



RV World



8 Leisure Drive, Quispamsis, NB
Highway 1, Exit 141
506 - 849 - 3363

1-888-388-7878

rentals@leisuretime.nb.ca
LeisureTimeSales.com



15 Chaparrel Rd, Waasis, NB, E3B 9Z4
Highway 2, Exit 297
506 - 446 - 3799

1-866-768-7700

rentals@rvworld.nb.ca
RVWorld.ca

2025 Rental Brochure & Rates

Book Your Adventure Today



EFFECTIVE JANUARY 1, 2025

CLASS "C" MOTORHOMES

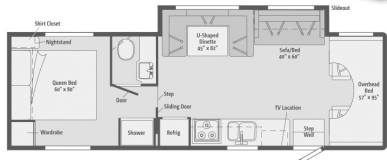

Available at
LTS Quispamsis
location only.

150 Free Kms Per Day
Minimum 1 Week Rental

TRAVEL TRAILERS

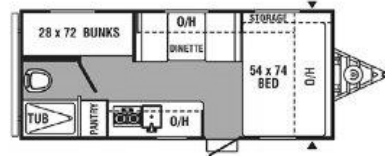

Weights Approx. 3500lbs
*Layout may vary by location.

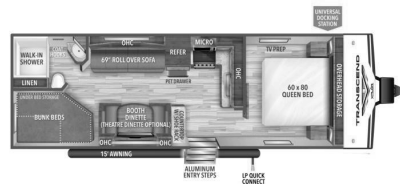

Sleeps 6-8
Weights Approx. 6000lbs
*Layout may vary by location.

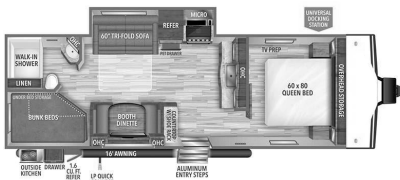

Sleeps 6-8
Weights Approx. 7000lbs
*Layout may vary by location.



GENERAL RENTAL TERMS & CONDITIONS

1. Non refundable reservation deposit is required at time of booking. Full payment of rental fee balance will be due upon departure. Reservation deposit may be refunded if rental vehicle can be rebooked.
2. Some vehicles shown may not be available for prescribed times. If for any reason the reserved vehicle is not available, the company reserves the right to substitute a vehicle of equal or higher value at no extra cost. If a lower rated vehicle is to be offered, the company's responsibility is limited to refunding the cost difference between the two vehicles. If this is not satisfactory, the company's liability will be limited to all monies paid.
3. Mandatory Insurance Coverage (where applicable) provided at our prescribed daily rate is 2,000,000 PL/PD with a \$1000.00 collision deductible.
4. Renters must be 25 years of age with a valid driver's license.
5. All fuel purchases (where applicable) are the responsibility of the renter.
6. Additional charges may be incurred: (ie. Propane, cleanup, late fees).
7. Mechanical repairs will be covered by the company. Any repair up to \$50.00 can be paid by renter and will be reimbursed upon return if accompanied by a valid receipt. Repairs over \$50.00 must have prior authorization. The company will not be responsible for any incidental consequential costs. In the event of a breakdown, liability will be limited to a refund of rental charges for any day's loss of use.
8. Vehicles to be picked up between the hours of 2 pm and 4 pm on departure day and returned no later than 12 noon on date of return or late fee will be charged.
9. Vehicles must be returned clean, holding tanks empty, gas and propane full or charges will be incurred.
10. No Smoking or Pets allowed in vehicles.

ADDITIONAL FEES

MOTORHOME INSURANCE \$25/DAY
Covers 2 million PL/PD with \$1000 deductible

DAMAGE DEPOSIT.....\$1000
Authorized on Credit Card

RESERVATION DEPOSIT

MOTORHOMES\$500/WEEK

TRAVEL TRAILERS\$200/WEEK

Some restrictions may apply. Availability & rental rates may vary at each location and are subject to change without notice.